

NEW



# ASSEMBLY TOOL FOR HSK CLAMPING SETS

Easy, quick and reliable assembly of HSK clamping sets

**RÖHM**  
driven by technology

# ASSEMBLY TOOL FOR HSK CLAMPING SETS

Ease of handling, rapid operation and reliable functionality – that sums up what RÖHM was aiming for in developing its new assembly tool for HSK clamping sets, and the result is a resounding success. Now just a few swift operations are all it takes to assemble clamping sets on the spindle quickly and reliably.

## BENEFITS AT A GLANCE

- ⌚ Massive time saving as assembly of the clamping sets only takes seconds
- 🛡️ Avoidance of damage to the clamping set and spindle
- 👤 User-friendly and reliable handling of the assembly tool

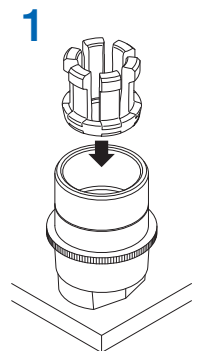

Insert segment collet in assembly tool

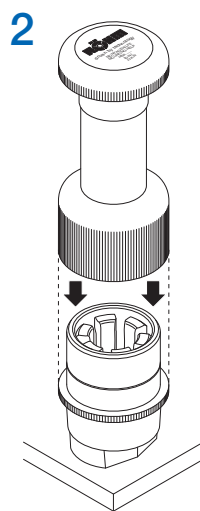

Close assembly tool

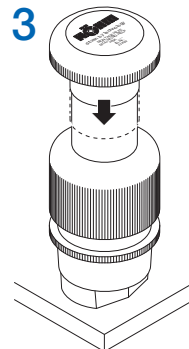

Pre-positioning of the segment collet

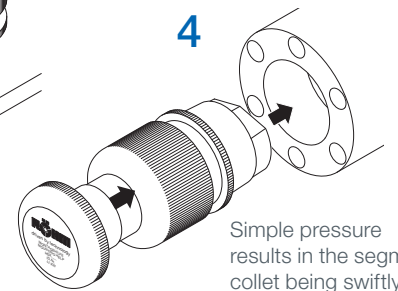

Simple pressure results in the segment collet being swiftly and reliably mounted on the spindle shaft



More information from the video at:  
[www.roehm.biz/assemblytool](http://www.roehm.biz/assemblytool)

ID	HSK-A/C/E/T	HSK-B/D/F
1329030	25 (only HSK E)	32 (only HSK F)
1329025	32	40
1329015	40	50
1329001	50	63
1324230	63	80
1329020	80	100
1329010	100	125
1329035	125	160

### SUITABLE FOR

- ⌚ Obtainable for all HSK sizes from 25 to 125
- ⌚ Functions with all HSK variants A-F & T
- ⌚ Suitable for RÖHM segment collets with short slender segments
- ⌚ Assembly tool for RÖHM segment chucks in longer versions are obtainable on request

